



# LED...A70..4-..Q Series Sealed High-Intensity Area Lights

*High-Power Lighting for use with PresencePLUS® and Other Vision Systems*

## Features



- Rugged, waterproof housing, rated IEC IP68
- Compact area light for PresencePLUS and other Vision systems
- Five extremely bright LEDs for illumination of targets from 0.15 meters to beyond 2 meters
- Smooth exterior for easy cleaning during washdown
- Optically isolated strobe signal
- Available with 316 stainless steel or nickel-plated aluminum housing and a choice of either acrylic or tempered optical glass windows
- Fixed and adjustable intensity (see models below)
- Selectable Active High or Active Low strobe option

## Models

Model*			LED Color	Housing	Optional Ambient Light Filter Kit for PresencePLUS Cameras
Acrylic Window	Glass Window	Diffuse Window (acrylic)			
LEDIA70AP4-XQ	LEDIA70AG4-XQ	LEDILA70AD4-XQ	Infrared, 850 nm	Nickel-plated aluminum	FLTI
LEDRA70AP4-XQ	LEDRA70AG4-XQ	LEDRA70AD4-XQ	Red, 625 nm		FLTR
LEDBA70AP4-XQ	LEDBA70AG4-XQ	LEDBA70AD4-XQ	Blue, 470 nm		FLTB
LEDGA70AP4-XQ	LEDGA70AG4-XQ	LEDGA70AD4-XQ	Green, 530 nm		FLTG
LEDWA70AP4-XQ	LEDWA70AG4-XQ	LEDWA70AD4-XQ	White, 5500 K		FLTB or FLTG
LEDIA70SSP4-XQ	LEDIA70SSG4-XQ	LEDIA70SSD4-XQ	Infrared, 850 nm	316 Stainless Steel	FLTI
LEDRA70SSP4-XQ	LEDRA70SSG4-XQ	LEDRA70SSD4-XQ	Red, 625 nm		FLTR
LEDBA70SSP4-XQ	LEDBA70SSG4-XQ	LEDBA70SSD4-XQ	Blue, 470 nm		FLTB

Model*			LED Color	Housing	Optional Ambient Light Filter Kit for PresencePLUS Cameras
Acrylic Window	Glass Window	Diffuse Window (acrylic)			
LEDGA70SSP4-XQ	LEDGA70SSG4-XQ	LEDGA70SSD4-XQ	Green, 530 nm		FLTG
LEDWA70SSP4-XQ	LEDWA70SSG4-XQ	LEDWA70SSD4-XQ	White, 5500 K		FLTB or FLTG

\* For models with controllable intensity, replace "XQ" with "PQ" in the model number (for example, LEDRA70AP4-PQ).

## Light Adjustment for Controllable Intensity Models

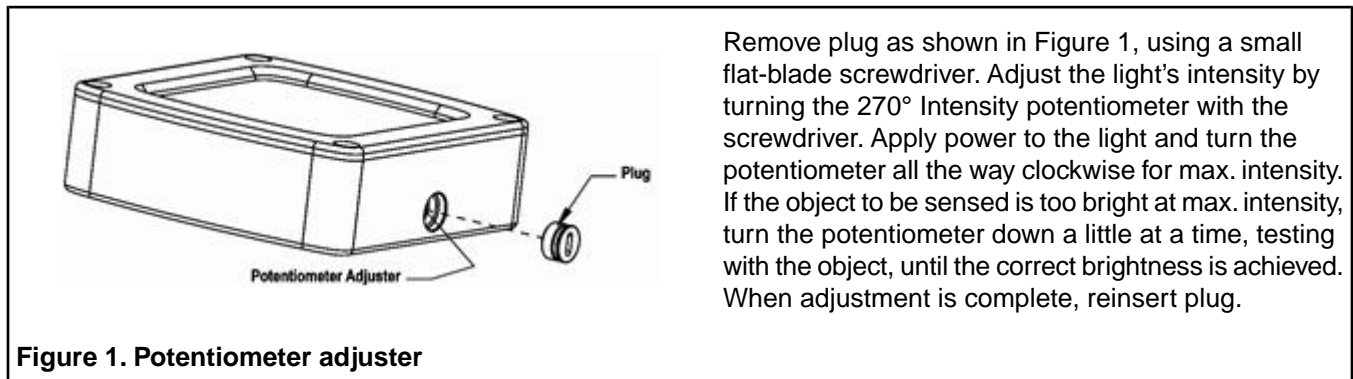

## Specifications

Feature	Description
<b>Light Source</b>	Five high-intensity LEDs; see models table for wavelength
<b>Illumination</b>	610 mm (24") diameter usable light pattern at 1 m
<b>Strobe</b>	Optically isolated
<b>Supply Voltage and Current</b>	<p><b>Operating Voltage:</b> 24V dc <math>\pm</math>10%</p> <p><b>Strobe Voltage:</b> 5-24V dc @ 15 mA maximum</p> <p><b>Current Draw at Full Intensity:</b> 350 mA max</p> <p>Built-in constant current regulator for LEDs</p> <p>Potentiometer controls variable intensity for "P" models</p>
<b>Connections</b>	5 pin Euro-style (M12) male connector; accessory cable required for operation, see Cables for options
<b>Construction</b>	<b>Housing:</b> nickel-plated aluminum or 316 stainless steel, depending on model

Feature	Description
	<b>Window:</b> acrylic or glass, depending on model
<b>Environmental Rating</b>	<b>Nickel-plated models:</b> IEC IP68 <b>Stainless steel models:</b> NEMA 4X; IP68
<b>Useful Life</b>	50,000 hours (LED ON time). When operated within specifications, output will decrease less than 30% after 50,000 hours.
<b>Operating Conditions</b>	<b>Temperature:</b> 0° to +50° C (+32° to 122° F)

## Dimensions

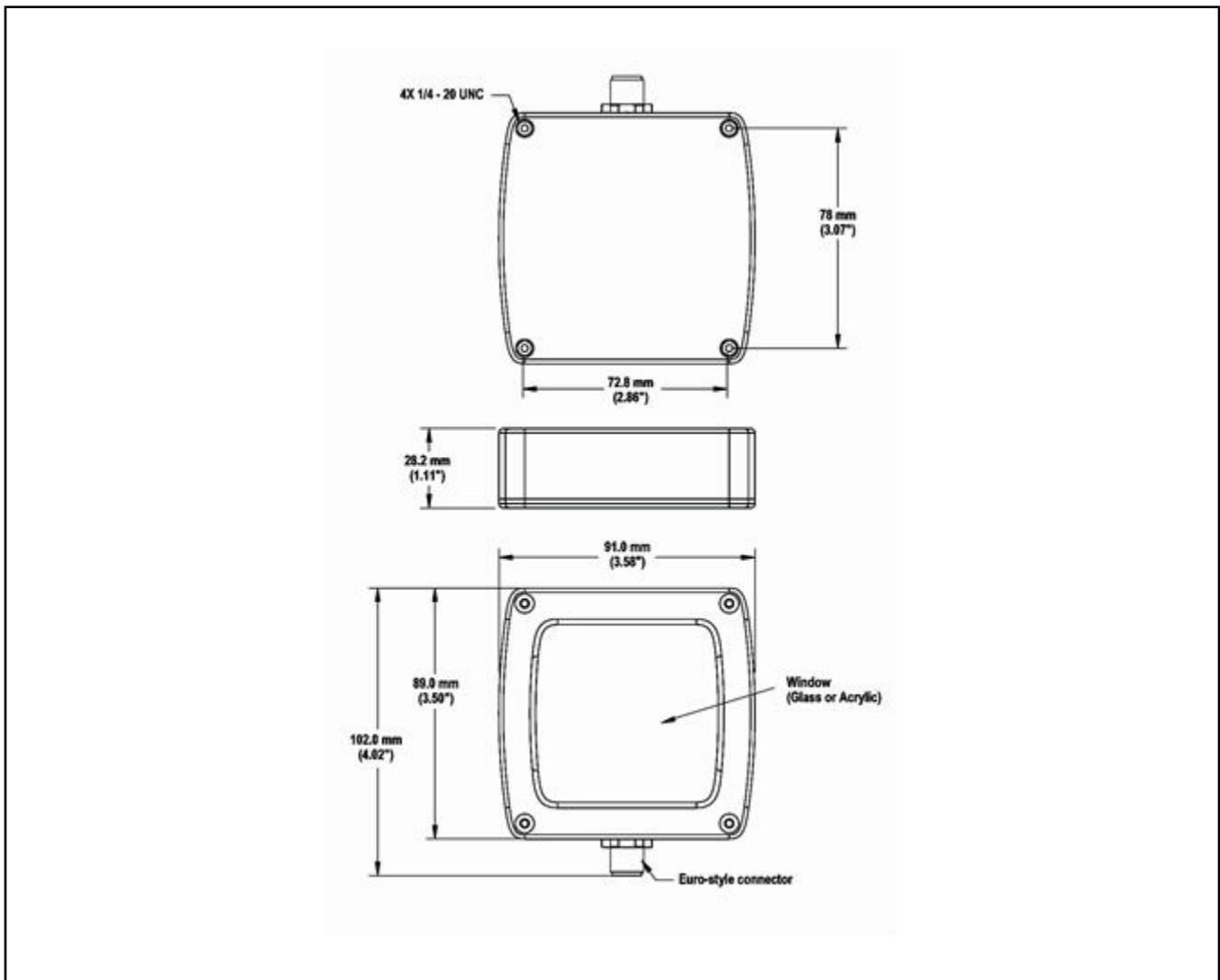

## Wiring Table

Wire Purpose	Cable Wire Color*	Continuous On Mode	Strobed Mode	PresencePlus Pro Controller Terminal Block
Power Wires	Brown (1)	+24V dc	+24V dc	Pin 01
	Blue (3)	common	common	Pin 02
Strobe Polarity Control	Gray (5)	open	<b>Active Low:</b> open <b>Active High:</b> connect to common (Blue wire)	Pin 02
Strobe Voltage Wires	White (2)	open	0V dc = ON (Active Low)  0V dc = OFF (Active High)  +5 to 24V dc = OFF (Active Low)  +5 to 24V dc = ON (Active High)	Pin 04
	Black (4)	open	Strobe common	Pin 02

The diagram shows a circular 5-pin connector. Five pins are arranged in a circle with a center pin. Arrows point from labels to each pin: White (2) Strobe (+) at the top-left, Blue (3) Common at the bottom-left, Brown (1) +24V dc at the top-right, Black (4) Strobe common at the bottom-right, and Gray (5) Active High/Active Low\*\* at the center.

**Figure 1: Pinouts**

\* For Banner-supplied wire.

\*\*Pinouts of the original 4-pin connector is the same as above, but without the center pin (Gray wire).

**Note:** To meet CE certification requirements, the light needs to be connected to earth ground.

## Cables

Model	Length	Description	Use With
<b>MQDC20-506</b>	2 m (6')	5-wire cable, straight female Euro-style (M12) connector at one end; flying leads at opposite end	Nickel-plated models
<b>MQDC20-515</b>	5 m (15')		
<b>MQDC20-530</b>	9 m (30')		
<b>MQDC20SS-506</b>	2 m (6')	5-wire cable, straight female Euro-style (M12) 316 stainless steel connector at one end; flying leads at opposite end	Stainless steel models
<b>MQDC20SS-515</b>	5 m (15')		
<b>MQDC20SS-530</b>	9 m (30')		

 **Note:** These 5-wire cables can also be used on 4-pin connector lights.

## Accessory Brackets

<b>SMBASCM</b>	<ul style="list-style-type: none"> <li>• 316 stainless steel column-mounting bracket with 430 stainless steel threaded insert</li> <li>• Four ¼-20 stainless steel screws included</li> </ul>	
----------------	---	---

## Replacement Window Kits

Model	Description
<b>LEDA70SW-P</b>	Clear acrylic
<b>LEDA70SW-G</b>	Clear glass
<b>LEDA70SCDW-P</b>	Clear diffuse acrylic
<b>LEDA70SWDW-P</b>	White diffuse acrylic



Warranty: Banner Engineering Corp. will repair or replace, free of charge, any product of its manufacture found to be defective at the time it is returned to the factory during the warranty period. This warranty does not cover damage or liability for the improper application of Banner products. This warranty is in lieu of any other warranty either expressed or implied.